

PRICE LIST 2023



ECONOMICAL INSULATED GALVANIZED MONOBLOC SERIE 40

REV.1 DEL 15/05/2023



STANDARD INNER HEIGHT 221 CM – EXTERNAL 239 CM

TECHNICAL DETAILS

STRUCTURE: it's made up from base and roof profiles in galvanized metal sheet thickness **1,5 mm** and by columns thickness 1,0 mm. **Without longerons under floor.**

WALLS: varnished steel sandwich panels with expanded **polyurethane** foam insulation, thickness **mm 40**, colour **WHITE-GREY RAL 9002**.

ROOF: horizontal, made from corrugated sandwich panels with expanded **polyurethane** foam insulation, thickness **30/70 mm**.

FLOOR: walking area made with **PVC** sheets fixed to chipboard panel thickness **mm 18**, upper to the basic frame.

WINDOWS AND DOORS: in aluminium/PVC white **RAL 9010** colour, with mm 4 glass, safety bars.

01 external door cm 90x200H, 1/2 glass and 1/2 blind

01 sliding opening window 90x98H.

ELECTRICAL SYSTEM: provided with visible cables trough the inside walls.

01 round LED light 10W

01 socket

01 switch

01 ground wire switch, outside watertight box for the connection device, switch board equipped with magneto thermal device.

CODE	DIMENSIONS IN CM	PRICE
MOZIBA20A	205X205X221 H INT (239 EST)	€ 2.835,00
MOZIBA30A	300X205X221 H INT (239 EST)	€ 2.880,00
MOZIBA40A	400X205X221 H INT (239 EST)	€ 3.285,00

ON THE 3 MT MODEL THE WINDOW IS PLACED ON THE SHORT SIGHT.
TO SWITCH IT ON THE LONG SIGHT + € 215,00

INSULATED STANDARD MONOBLOC SERIE 40

REV.1 DEL 15/05/2023

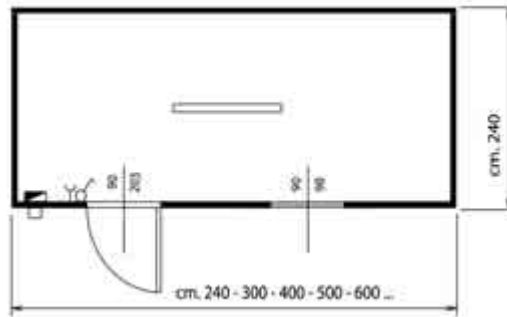

STANDARD INNER HEIGHT 221 CM – EXTERNAL 245 CM

TECHNICAL DETAILS

STRUCTURE: it is made up by base and roofing section bars which are connected through angular uprights. It is an all steel with **15/10 thickness**, zinc-plated sheets, electro welding, protected coated cycle on sight parts, **blue colour RAL 5017**. The complete floor is properly lifted from the ground from **two sleepers**.

WALLS: Sandwich modular panels, self-carrying walls, having pre-varnished white-grey and fret-plated sheets on both sides, insulated inside with self-extinguish expanded foam polyurethane. The whole thickness is **40 mm**.

ROOF: horizontal, made from corrugated sandwich panels with expanded **polyurethane** foam insulation, thickness **30/70 mm**.

FLOOR: walking area made with **PVC** sheets fixed to chipboard panel **thickness mm 18**, upper to the basic frame. The frame is made up of a zinc-plated tubular, electro-welded.

WINDOWS AND DOORS: aluminium/PVC, white RAL 9010, 4 mm glass, safety bars.

01 external door cm 90x200H upper part 4 mm glass + safety bars, blind lower part.

01 sliding opening window cm 90x98H

ELETTRICAL SYSTEM: provided with visible cables trough the inside walls.

01 LED lighting 40W

01 socket

01 switch

01 ground wire switch - outside watertight box, suitable for the web connection device - switch-board equipped with magneto thermal safety device.

FOR DISSASSEMBLED MONOBLOCKS +6%

CODE	DIMENSIONS IN CM	PRICE VERSION 221 CM INNER HEIGHT
MO40BA24A	240X240	€ 3.240,00
MO40BA30A	300X240	€ 3.480,00
MO40BA40A	400X240	€ 3.780,00
MO40BA50A	500X240	€ 4.285,00
MO40BA60A	600X240	€ 4.685,00

INSULATED STANDARD MONOBLOC SERIE 50

REV.1 DEL 15/05/2023

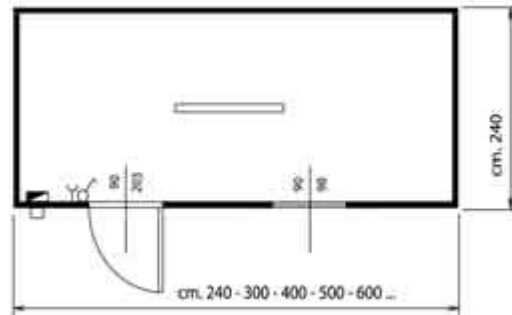

STANDARD INNER HEIGHT 223 CM - EXTERNAL 245 CM
 STANDARD INNER HEIGHT 240 CM – EXTERNAL 270 CM
 STANDARD INNER HEIGHT 270 CM – EXTERNAL 298 CM

TECHNICAL DETAILS

Same configuration as monobloc serie 40 except for the walls panels that are **50 mm thickness**.

Length **7** and **8 mt** are provided with two LED lightings.
 FOR DISSAMBLED MONOBLOCKS +6%

CODE	DIMENSIONS IN CM	PRICE H. INT. 223 H. EST. 247 (A)	PRICE H. INT. 240 H. EST. 270 (B)	PRICE H. INT. 270 H. EST. 298 (C)
MO50BA24A – B – C	240X240	€ 3.335,00	€ 3.435,00	€ 3.505,00
MO50BA30A – B – C	300X240	€ 3.525,00	€ 3.630,00	€ 3.810,00
MO50BA40A – B – C	400X240	€ 3.970,00	€ 4.095,00	€ 4.300,00
MO50BA50A – B – C	500X240	€ 4.475,00	€ 4.610,00	€ 4.840,00
MO50BA60A – B – C	600X240	€ 4.880,00	€ 5.030,00	€ 5.280,00
MO50BA70A – B – C	700X240	€ 5.845,00	€ 6.015,00	€ 6.320,00
MO50BA80A – B – C	800X240	€ 6.675,00	€ 6.880,00	€ 7.225,00

INSULATED STANDARD MONOBLOC SERIE 40 REINFORCED AND SUPERIMPOSABLE

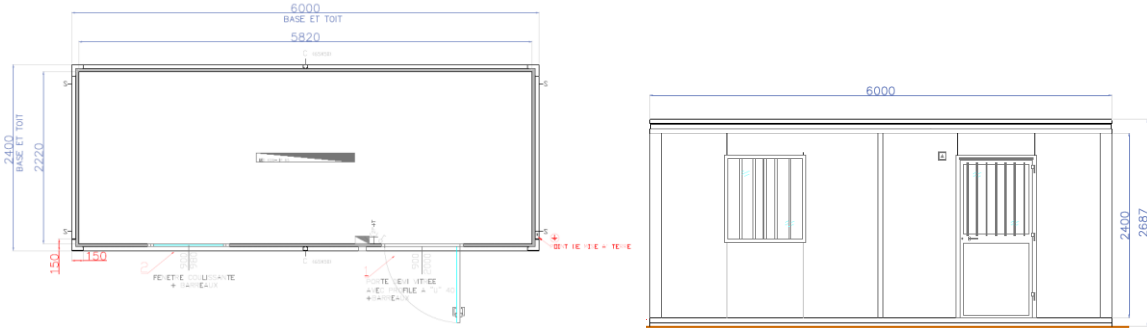

**STANDARD INNER HEIGHT 240 CM – EXTERNAL 269 CM
SUPERIMPOSABLE GROUND FLOOR + FIRST FLOOR**

TECHNICAL DETAILS

STRUCTURE: it is made up by base and roofing section bars which are connected through angular uprights. It is an all steel with **20/10 thickness**, zinc-plated sheets, electro welding, protected coated cycle on sight parts, **blue colour RAL 5017**. The complete floor is properly lifted from the ground from **two sleepers**.

WALLS: Sandwich modular panels, self-carrying walls, having pre-varnished white-grey and fret-plated sheets on both sides, insulated inside with self-extinguish expanded foam polyurethane. The whole thickness is **40 mm**.

ROOF: horizontal, made from corrugated sandwich panels with expanded **polyurethane** foam insulation, thickness **40/80 mm**.

FLOOR: walking area made with **PVC** sheets fixed to chipboard panel **thickness mm 18**, upper to the basic frame. The frame is made up of a zinc-plated tubular, electro-welded.

WINDOWS AND DOORS: aluminium/PVC, white RAL 9010, 4 mm glass, safety bars.
01 external door cm 90x200H upper part 4 mm glass + safety bars, blind lower part.
01 sliding opening window cm 90x98H

ELETTICAL SYSTEM: provided with visible cables trough the inside walls.

01 LED lighting 40W

01 socket

01 switch

01 ground wire switch - outside watertight box, suitable for the web connection device - switch-board equipped with magneto thermal safety device.

CODE	DIMENSIONS IN CM	PRIX VERSION 240 CM INTERNAL HEIGHT
MO40BA60B036	600X240	€ 7.200,00

COMBINED MONOBLOC SERIE 50

REV.1 DEL 15/05/2023

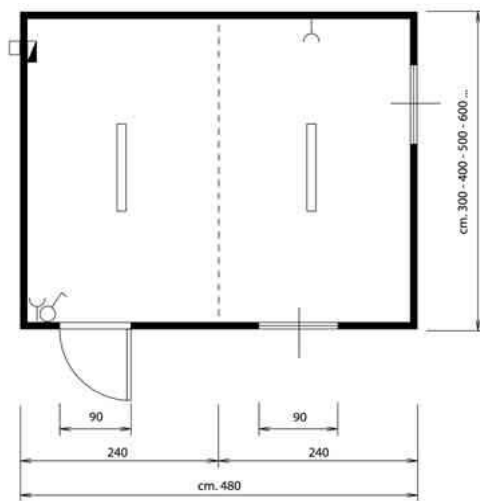

STANDARD INNER HEIGHT 223 CM - EXTERNAL 245 CM
STANDARD INNER HEIGHT 240 CM – EXTERNAL 270 CM
STANDARD INNER HEIGHT 270 CM – EXTERNAL 298 CM

TECHNICAL DETAILS

Same configuration as monobloc SERIES 40 except for the walls panels that are **50 mm thickness**.

WINDOWS AND DOORS: aluminium/PVC white RAL 9010 colour, 4 mm glass, safety bars.
 01 external door cm 90x200H upper part 4 mm glass + safety bars, blind lower part
 02 sliding opening windows cm 90x98H

ELETTRICAL SYSTEM: provided with visible cables trough the inside walls.
 02 LED lightings 40W
 02 sockets
 01 switch,
 01 ground wire switches - outside watertight box, suitable for the web connection device - switch-board equipped with magneto thermal safety device.

CODE	DIMENSIONS IN CM	PRICE H. INT. 223 H. EST. 247 (A)	PRICE H. INT. 240 H. EST. 270 (B)	PRICE H. INT. 270 H. EST. 298 (C)
MOABBA40A – B – C	400X480	€ 7.900,00	€ 8.200,00	€ 8.515,00
MOABBA50A – B – C	500X480	€ 8.990,00	€ 9.275,00	€ 9.610,00
MOABBA60A – B – C	600X480	€ 10.185,00	€ 10.595,00	€ 10.980,00
MOABBA70A – B – C	700X480	€ 11.700,00	€ 12.145,00	€ 12.730,00
MOABBA80A – B – C	800X480	€ 13.660,00	€ 14.180,00	€ 14.710,00

SUPERIMPOSABLE (G+1) EXPORT MONOBLOC SERIE 50

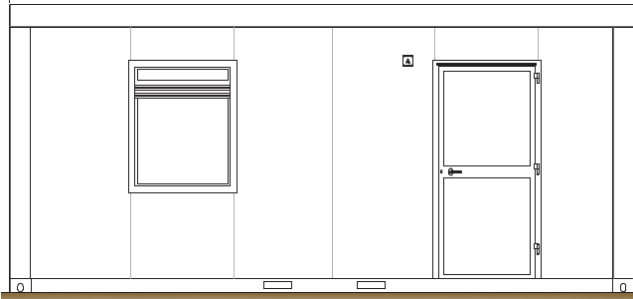

STANDARD INNER HEIGHT 223 CM - EXTERNAL 245 CM (A)
 STANDARD INNER HEIGHT 240 CM – EXTERNAL 270 CM (B)
 STANDARD INNER HEIGHT 270 CM – EXTERNAL 298 CM (C)

TECHNICAL DETAILS:

STRUCTURE: it is made up by base and roofing section bars which are connected through angular uprights. It is an all steel with **25/10 thickness**, zinc-plated sheets, electro welding, protected coated cycle on sight parts, **blue colour RAL 5017**.

WALLS: Sandwich modular panels, self-carrying walls, having pre-varnished white-grey and fret-plated sheets on both sides, insulated inside with self-extinguish expanded foam polyurethane. The whole thickness is **50 mm**.

ROOF: horizontal ceiling, whose panels have got the same features of those used for the walls. Fret sheet upper wall: flat thickness **50 mm**, fret thickness **90 mm**.

FLOOR: PVC floor fixed with a special glue to a **waterproof chipboard panel** thickness **18 mm**.

ISOLATION with sandwich panels **mm 30**, which is then fixed to a frame.

WINDOWS AND DOORS: aluminium/PVC white **RAL 9010** colour, **4/9/4 glasses**, PVC roll-up shutter.

01 blind door cm 90x200H

01 tilt and turn opening window cm 90x98H with PVC rolling shutter

ELECTRICAL SYSTEM: provided with visible cables trough the inside walls.

01 LED lighting 40W

01 switch

01 socket

01 ground wire switches - outside watertight box, suitable for the web connection device - switch-board equipped with magneto thermal safety device.

Model **8 / 9 mt** are provided with two LED lightings.

CODE	DIMENSIONS IN CM	PRICE	PRICE	PRICE
		H. INT. 229 H. EST. 259 (A)	H. INT. 250 H. EST. 280 (B)	H. INT. 280 H. EST. 310 (C)

MOEXBA60A – B – C	605X243,8	€ 9.425,00	€ 9.810,00	€ 10.185,00
MOEXBA70A – B – C	700X243,8	€ 10.745,00	€ 11.165,00	€ 11.720,00
MOEXBA80A – B – C	800X243,8	€ 12.390,00	€ 12.890,00	€ 13.410,00
MOEXBA90A – B – C	900X243,8	€ 12.930,00	€ 13.500,00	€ 14.085,00

FACILE



STRUCTURE: it is made by floor and roof steel galvanized profiles type S355 with **3 mm thickness**; the columns are 4 mm thickness; RAL 9002 colour.

FLOOR: walking area is made by **anti-slip PVC** which is fixed to a plan formed by **waterproofing panels** thickness **22 mm**.

Insulation is provided by **polystyrene** sheets having a total thickness of **60 mm**.

The **floor chassis** is closed below by the fitting of a **galvanized sheet** thickness **1 mm**.

Predisposition kit fitted into the floor chassis to be able to lift the module by **forks elevator**.

ROOF: horizontal, it is realized by sandwich panels insulated by polyurethane foams. Flat thickness of the panel is **30 mm** while the fret thickness is **70 mm**.

Under the roof, **insulation** is provided by the insertion of one **mineral fibreglass layer**, having a total thickness of **50 mm**. A "C21" pre-painted sheet having staved finishings makes the ceiling.

WALLS: realized by sandwich panels, total thickness **40 mm**; insulation inside is ensured by **polyurethane** foams; the external side of the panel is made by «C21(white-grey) embossed sheet finishing» while the internal side is made by «C21(white-grey) straight sheet finishing».

Panels width: 980 mm/1200mm

DOORS & WINDOWS: aluminium/PVC, pre-painted white RAL 9010 colour.

01 blind door mm 1000x2205H

01 window sliding opening window mm 1000x1200H equipped with camera glass and PVC rolling shutter

ELECTRICAL INSTALLATION

02 LED lightings 40W

02 sockets

01 socket for A/C unit

01 box for connection of the heater unit

01 VDE socket into ceiling for additional light control

01 electrical panel installed into ceiling

01 external watertight box installed into ceiling

01 ground wiring

01 electrical panel switch for additional light control

01 electrical convector 2000W

Same configuration for **FACILE SERIES 60** with these differences: walls panels thickness mm 60, roof insulation thickness mm 50+50 with mineral fibreglass layers, internal height cm 250.

CODE	DIMENSIONS IN CM	DISASSEMBLED	ASSEMBLED
MOMFBA40A	603,5X243,5X231HI (278,5 HE)	€ 10.230,00	€ 10.615,00
MOMFBA60C	603,5X243,5X250HI (297,5 HE)	€ 10.695,00	€ 11.080,00
MOMFST40A	FACILE STRUCTURE SERIES 40	€ 7.500,00	-
MOMFST60A	FACILE STRUCTURE SERIES 60	€ 7.570,00	-

ACCESSORIES FOR MONOBLOCKS

CONNECTION KITS TO JOINT/COUPLE THE MONOBLOCKS

CODE	DIMENSIONS IN CM	PRICE
	CONNECTION KIT 243,8 CM	€ 290,00
	CONNECTION KIT 600 CM	€ 540,00

FORKLIFT KIT

CODE	DIMENSIONS	PRICE
	FORKLIFT KIT MONOBLOCK FROM 300 CM TO 500 CM	€ 370,00
	FORKLIFT KIT MONOBLOCK FROM 600 CM	€ 440,00

ACCESS RAMP FROM CORRUGATED STEEL SHEET WITH CM 100

Realized with steel structure maximum gradient 8% with 2 m of landing.

CODE	DIMENSIONS	PRICE
	H 12 CM – LENGTH M 3,2	€ 1.965,00
	H 14 CM – LENGTH M 3,6	€ 2.205,00
	H 18 CM – LENGTH M 6,0	€ 2.845,00
	H 28 CM – LENGTH M 8,0	€ 4.350,00

DIFFERENT PLUMBING CONFIGURATION INSTALLED INSIDE THE MONOBLOCKS

HYDRAULIC SYSTEM: the facility for baths is carried out in the standard with path at view along the internal walls, equipped with pipes, fittings, pipe fittings, siphons, drains and sanitary in quantity and quality required. Possibility to customize with different finishes on request.

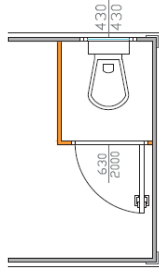
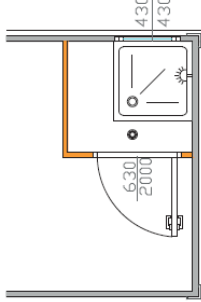
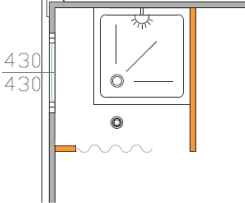
SIM 01	STANDARD EQUIPMENT	€ 1.695,00
	<p>Dividing walls as per sketch</p> <ul style="list-style-type: none"> 01 internal blind door cm 63x200H 01 tilt opening window cm 43x43H with printed glass 01 watertight ceiling lamp 60W IP65 01 switch 01 ceramic English WC 01 toilet paper roll holder 01 toilet brush 	
	<p>Dividing walls as per sketch</p> <ul style="list-style-type: none"> 01 internal blind door cm 63x200H 01 tilt opening window cm 43x43H with printed glass 01 watertight ceiling lamp 60W IP65 01 switch 01 ceramic shower cm 70x70 01 shower curtain 01 soap dish 01 shower dish 01 water drain floor 01 electrical boiler lt. 30 + socket 	€ 2.525,00
	<p>Dividing walls as per sketch</p> <ul style="list-style-type: none"> 01 shower curtain 01 tilt opening window cm 43x43H with printed glass 01 watertight ceiling lamp 60W IP65 01 switch 01 ceramic shower cm 70x70 01 soap dish 01 shower head 01 water drain floor 01 electrical boiler lt. 30 + socket 	€ 2.155,00

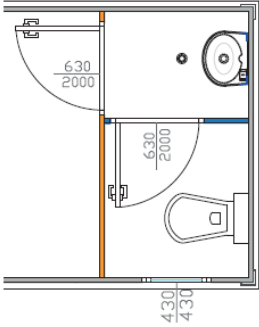
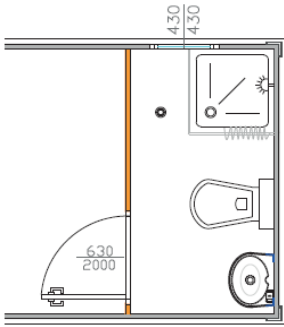
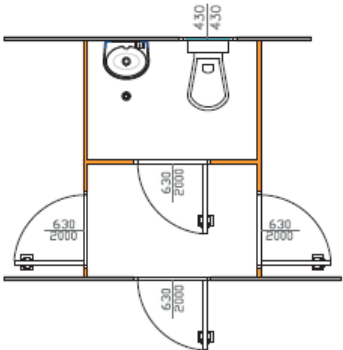
SIM 04	STANDARD EQUIPMENT	€ 2.250,00
	<p>Dividing walls as per sketch</p> <ul style="list-style-type: none"> 01 internal blind door cm 63x200H 01 tilt opening window cm 43x43H with printed glass 01 watertight ceiling lamp 60W IP65 01 switch 01 socket 01 ceramic English WC 01 toilet paper roll holder 01 toilet brush 01 ABS washbasin cm 45 01 soap dish 01 mirror <p>Additional price for additional wall with blind door and watertight ceiling lamp (dressing room)</p>	<p>€ 660,00</p>
SIM 05	STANDARD EQUIPMENT	€ 3.540,00
	<p>Dividing walls as per sketch</p> <ul style="list-style-type: none"> 01 internal blind cm 63x200H 01 tilt opening window cm 43x43H with printed glass 01 watertight ceiling lamp 60W IP65 01 switch 01 socket 01 ceramic English WC 01 toilet paper roll holder 01 toilet brush 01 ABS washbasin cm 45 01 mirror 01 ceramic shower cm 70x70 01 shower curtain 01 shower head 01 soap dish 01 water drain floor 01 electrical boiler lt. 30 + socket 	
SIM 06	STANDARD EQUIPMENT	€ 3.895,00
	<p>Dividing walls as per sketch</p> <ul style="list-style-type: none"> 03 internal blind doors cm 63x200H 01 tilt opening window cm 43x43H with printed glass 02 watertight ceiling lamps 60W IP65 02 switch 02 sockets 01 ceramic English WC 01 toilet paper roll holder 01 toilet brush 01 ABS washbasin cm 45 01 mirror 	

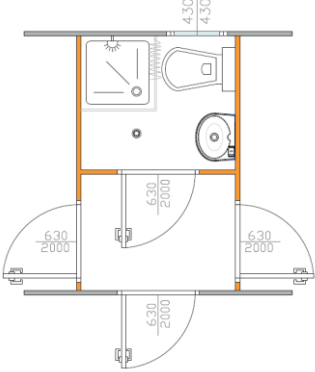
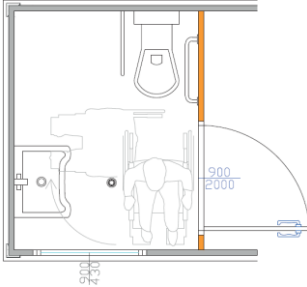
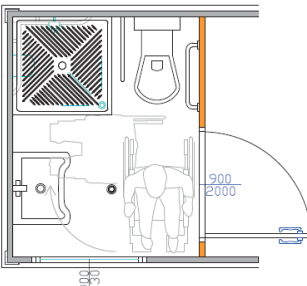
SIM 07	STANDARD EQUIPMENT	€ 5.095,00
	<p>Dividing walls as per sketch</p> <ul style="list-style-type: none"> 03 internal blind doors cm 63x200H 01 tilt opening window cm 43x43H with printed glass 02 watertight ceiling lamps 60W IP65 02 switch 02 sockets 01 ceramic English WC 01 toilet paper roll holder 01 toilet brush 01 ABS washbasin cm 45 01 mirror 01 ceramic shower cm 70x70 01 curtain shower 01 soap dish 01 shower head 01 water drain floor 01 electrical boiler lt. 30 + socket 	
SIM 08	STANDARD EQUIPMENT	€ 3.460,00
	<p>Dividing walls as per sketch</p> <ul style="list-style-type: none"> 01 internal blind door cm 90x200H with clinic handle 01 tilt opening window cm 90x43H with printed glass 01 watertight ceiling lamp 60W IP65 01 switch 01 socket 01 emergency light 01 electric device with acoustic and visual alarm 01 release button 01 WC for disabled 01 toilet paper roll holder 01 toilet brush Fixed handle for disabled 01 ceramic washbasin for disabled 01 mirror 01 water drain floor 	
SIM 09	STANDARD EQUIPMENT	€ 4.770,00
	<p>Same configuration of SIM 08 with:</p> <ul style="list-style-type: none"> 01 ceramic shower cm 90x90 01 chair 01 water drain floor 01 electrical boiler lt. 30 + socket 	

SANITARY MONOBLOCKS

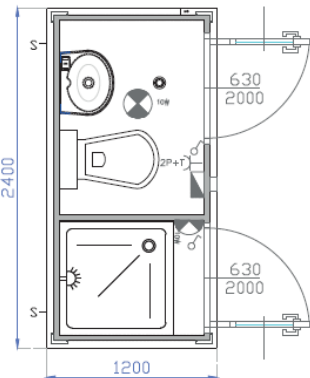
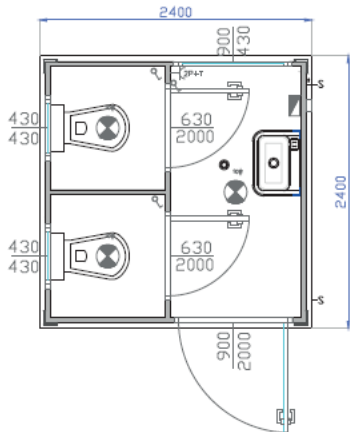
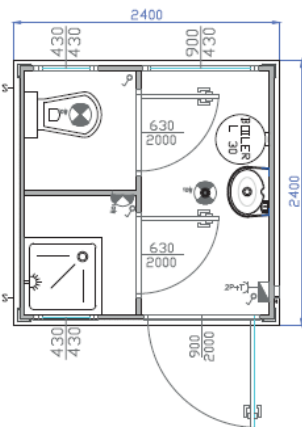

MOSEBAS01	120X116 CM	€ 3.125,00
	<ul style="list-style-type: none"> 01 external blind door cm 63x200H with tilt opening window 01 watertight ceiling lamp LED 10W 01 switch 01 socket 01 ABS washbasin 35 cm 01 mirror 01 ceramic English WC Bathroom accessories 	
MOSEBAS02	120X240 CM	€ 4.195,00
	<p>Dividing walls as per sketch</p> <ul style="list-style-type: none"> 01 external blind door cm 63x200H with tilt opening window 01 internal blind door cm 63x200H with free/occupy device 01 tilt opening window cm 43x43H 02 watertight ceiling lamps LED 10W IP65 02 switches 01 socket 01 ABS washbasin 55 cm 01 mirror 01 ceramic English WC Bathroom accessories 	
MOSEBAS03	120X240 CM	€ 4.955,00
	<p>Dividing walls as per sketch</p> <ul style="list-style-type: none"> 02 external blind doors cm 63x200H with tilt opening window 02 watertight ceiling lamps LED 10W IP65 02 switches 02 sockets 02 ABS washbasins 35 cm 02 mirrors 02 ceramic English WC Bathroom accessories 	

MOSEBAS04	120X240 CM	€ 5.540,00
	<p>Dividing walls as per sketch</p> <p>02 external blind doors cm 63x200H with tilt opening window 02 watertight ceiling lamps LED 10W IP65 02 switches 01 socket 01 ABS washbasin 35 cm 01 mirror 01 ceramic English WC 01 ceramic shower cm 70x70 01 shower curtain 01 water drain floor 01 electrical boiler lt. 30 + socket</p>	
	<p>Dividing walls as per sketch</p> <p>01 external door cm 90x200H upper part 4mm glass + safety bars, blind lower part 02 internal blind doors cm 63x200H with free/occupy device 02 tilt opening windows cm 43x43H with printed glass 01 sliding opening window cm 90x43H with printed glass 03 watertight ceiling lamps LED 10W IP65 03 switches 01 socket 01 ABS washbasin 55 cm 01 mirror 02 ceramic English WC</p>	€ 6.685,00
	<p>Dividing walls as per sketch</p> <p>01 external door cm 90x200H upper part 4mm glass + safety bars, blind lower part 02 internal blind doors cm 63x200H with free/occupy device 02 tilt opening windows cm 43x43H with printed glass 01 sliding opening window cm 90x43H with printed glass 03 watertight ceiling lamps LED 10W IP65 03 switches 01 socket 01 ABS washbasin 55 cm 01 mirror 01 ceramic shower 70x70 01 curtain shower 01 water drain floor 01 ceramic English WC 01 electrical boiler lt. 30 + socket</p>	€ 7.510,00

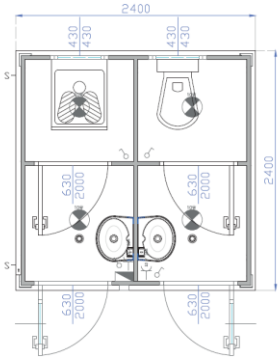
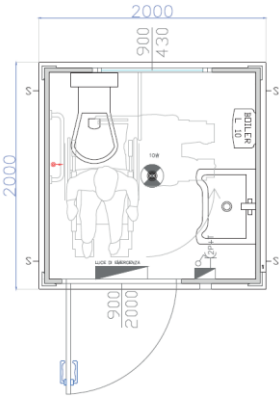
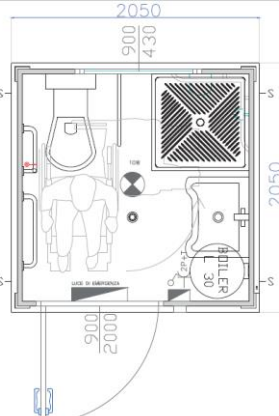
MOSEBAS07	240X240 CM	€ 8.200,00	
	<p>Dividing walls as per sketch</p> <ul style="list-style-type: none"> 02 external blind doors cm 63x200H with tilt opening window 02 internal blind doors cm 63x200H with free/occupy device 02 tilt opening windows cm 43x43H with printed glass 04 watertight ceiling lamps LED 10W IP65 04 switches 02 sockets 02 ABS washbasins 45 cm 02 mirrors 02 ceramic English WC 		
<th data-bbox="186 757 651 801">MOSEBAS08</th> <th data-bbox="651 757 1305 801">200X200 CM</th> <th data-bbox="1305 757 1506 801">€ 5.600,00</th>	MOSEBAS08	200X200 CM	€ 5.600,00
	<ul style="list-style-type: none"> 01 external blind door cm 90x200H with clinic handle 01 tilt opening windows cm 90x43H with printed glass 01 watertight ceiling lamp LED 10W IP65 01 switch 01 socket 01 electric device with acoustic and visual alarm 01 release button 01 emergency light 01 ceramic WC for disabled 01 washbasin for disabled 01 mirror Fixed handles for disabled <p>ACCESS RAMP EXCLUDED</p>		
<th data-bbox="186 1254 651 1299">MOSEBAS09</th> <th data-bbox="651 1254 1305 1299">200X200 CM</th> <th data-bbox="1305 1254 1506 1299">€ 6.585,00</th>	MOSEBAS09	200X200 CM	€ 6.585,00
	<ul style="list-style-type: none"> 01 external blind door cm 90x200H with clinic handle 01 tilt opening windows cm 90x43H with printed glass 01 watertight ceiling lamp LED 10W IP65 01 switch 01 socket 01 electric device with acoustic and visual alarm 01 release button 01 emergency light 01 ceramic WC for disabled 01 washbasin for disabled 01 mirror 01 ceramic shower 01 chair for disabled 01 waste waste trap 01 electrical boiler lt. 30 + socket Fixed handles for disabled <p>ACCESS RAMP EXCLUDED</p>		

PRICE LIST ELECTRICAL BOILER

THE THERMOSTATIC MIXER AND THE PRESSURE REDUCER **ARE NOT INCLUDED** WITH BOILER.

THE PRESSURE REDUCER MUST BE INCLUDED IF THERE ARE TIMER TAPS.
WHENEVER THERE IS A BOILER, THERE WILL BE ALSO A MIXER.

ARTICLE DESCRIPTION	PRICE
BOILER LT. 10 with support and socket	€ 550,00
BOILER LT. 30 with support and socket	€ 600,00
BOILER LT. 50 with support and socket	€ 640,00
BOILER LT. 80 with support and socket	€ 880,00
BOILER LT. 100 with support and socket	€ 940,00
BOILER LT. 150 with support and socket	€ 1.060,00
BOILER LT. 200 with support and socket	€ 1.280,00

PRICE LIST AIR CONDITIONER

ARTICLE DESCRIPTION	PRICE
AIR CONDITIONER 9000BTU/H F-GAS	€ 1.270,00
AIR CONDITIONER 12000BTU/H F-GAS	€ 1.300,00
AIR CONDITIONER 18000BTU/H F-GAS	€ 1.750,00
DUAL SPLIT AIR CONDITIONER 18000BTU/H F-GAS	€ 3.170,00

PRICE LIST OF HYDRAULIC INSTALLATION ACCESSORIES

CODE	DESCRIPTION	PRICE
Y7A00002	CERAMIC WASHBASIN CM 50 + H/C water mixer tap + mirror	€ 465,00
Y7A00003	CERAMIC WASHBASIN CM 60 + H/C water mixer tap + mirror	€ 485,00
Y7A00007	KITCHEN SINGLE SINK WITH CABINET CM 90 + H/C water mixer tap	€ 790,00
Y7A00009	ABS SINK CM 95 WITH NR.02 H/C WATER MIXER TAPS + mirror	€ 550,00
Y7A00011	ABS SINK CM 145 WITH NR.03 H/C WATER MIXER TAPS + mirror	€ 640,00
Y7A00012	STEEL SINK CM 95 WITH NR.02 H/C WATER MIXER TAPS + mirror	€ 915,00
Y7A00013	STEEL SINK CM 145 WITH NR.03 H/C WATER MIXER TAPS + mirror	€ 1.045,00
Y7A00014	BIDET + H/C water mixer tap + soap dish	€ 420,00
Y7A00016	CERAMIC WC WITH EVACUATION THROUGHOUT THE WALL PANELS WC – toilet WC tank – toilet seat – toilet paper roll holder – toilet brush	€ 475,00
Y7A00017	ABS ASIAN STYLE TOILET WC Asian style toilet WC – toilet tank – toilet paper roll holder – toilet brush	€ 530,00
Y7A00018	INOX ASIAN STYLE TOILET WC Asian style toilet WC –pneumatic tank with push button – toilet paper roll holder – toilet brush	€ 815,00
Y7A00019	CERAMIC SHOWER TRAY CM 70X70 Shower – shower head - water mixer tap for shower – soap dish	€ 615,00
Y7A00020	CERAMIC SHOWER TRAY CM 80X80 Shower – shower head - water mixer tap for shower – soap dish	€ 660,00
Y7A00021	CERAMIC SHOWER TRAY CM 90X90 Shower – shower head - water mixer tap for shower – soap dish	€ 765,00
Y7A00025	INOX SHOWER TRAY CM 80X80 Shower – shower head - water mixer tap for shower – soap dish	€ 770,00
Y7A00027	CURTAIN SHOWER	€ 60,00
Y7A00028	SHOWER BOX	€ 380,00
Y7A00029	CERAMIC URINAL (DIVIDING PARTITION EXCLUDED)	€ 435,00
Y7A00030_1/2''	SIMPLE MIXING VALVE 1/2''	€ 265,00
Y7A00031_1''	PRESSURE REDUCER 1''	€ 430,00
Y7A00031_1-1/2''	PRESSURE REDUCER 1-1/2''	€ 1.100,00
Y7A00035	DISABLED SHOWER SEAT	€ 280,00
Y7A00036	HAND SHOWER	€ 100,00
Y7A00037	SHOWER HAND RAIL FOR DISABLED	€ 80,00
Y7A00039	COAT HANGERS	€ 30,00
Y7A00040	COAT HANGERS 5P	€ 95,00
Y7A00041	DISABLED SHOWER BAR	€ 165,00
Y7A00043	SOAP DISPENSER 1 LT	€ 70,00
Y7A00044	PAPER DISPENSER	€ 70,00
Y7A00059	TIMING BUTTON "PRESTO TYPE"	€ 35,00
Y7A00060	ADDITIONAL FOR TIMING MIXER TAP	€ 105,00
Y7A00061	EVACUATION VALVE FOR ELECTRIC BOILER	€ 80,00
Y7A00062	EXPANSION TANK 50 LT	€ 420,00
Y7A00063	HOSE TAP	€ 60,00
Y7A00064	WASHING MACHINE SET-UP	€ 120,00
Y7A00065	WASHING MACHINE/DISHWASHER DRAINS	€ 110,00
Y7A00068	SHOWER HEAD (COLLECTIVE SHOWERS FOR CHANGING ROOMS)	€ 420,00
Y7A00070	MANUAL AIR VENT VALVE 1/2'' M FOR SHOWER	€ 35,00

PRICE LIST FOR ELECTRIC INSTALLATION ACCESSORIES

CODE	DESCRIPTION	PRICE
Y7KA0001	LED LIGHTING 40W	€ 125,00
Y7KA0002	PANEL LED LIGHTING 40W	€ 185,00
Y7KA0003	EXTERNAL OVAL LED LIGHTING IP65	€ 85,00
Y7KA0006	SANITARY ROUND LED LIGHTING IP65	€ 130,00
Y7KA0007	EMERGENCY LIGHT 11W	€ 170,00
Y7KA0008	EMERGENCY LIGHT 18W	€ 195,00
Y7KA0011	SOCKET 10/16 GW IP44	€ 70,00
Y7KA0012	SOCKET 10/16 GW IP65	€ 80,00
Y7KA0013	FRENCH SOCKET GW IP44	€ 75,00
Y7KA0014	SWISS SOCKET GW IP44	€ 75,00
Y7KA0015	ENGLISH SOCKET GW IP44	€ 80,00
Y7KA0016	UNEL SOCKET 10/16 GW IP44	€ 80,00
Y7KA0017	UNEL/FRENCH SOCKET 10/16 GW IP65	€ 80,00
Y7KA0018	DATA RJ11/PHONE RJ45 SOCKET GW IP44	€ 95,00
Y7KA0023	ELECTRICAL BOILER LT. 15-150 SOCKET (SPECIFIC ELECTRIC LINE)	€ 140,00
Y7KA0024	AIR CONDITIONER/CONVECTOR SOCKET (SPECIFIC ELECTRIC LINE)	€ 120,00
Y7KA0025	SWITCHBOARD WITH SAFETY DEVICE 2x16A 6Ka id 0,03 IP44 + EXTERNAL WATERTIGHT BOX	€ 280,00
Y7KA0026	SWITCHBOARD WITH SAFETY DEVICE 2X16A 6Ka id 0,03 IP65 + EXTERNAL WATERTIGHT BOX	€ 320,00
Y7KA0027	EXTERNAL UE SOCKET 90° 1P+N 16A IP65 220V	€ 50,00
Y7KA0028	EXTERNAL UE SOCKET 90° 1P+N 32A IP65 220V	€ 60,00
Y7KA0029	ELECTRIC DEVICE WITH ACOUSTIC AND VISUAL ALARM + RELEASE BUTTON	€ 230,00
Y7KA0030	EXTERNAL UE SOCKET 90° 3P+N 16A IP65 380V	€ 85,00
Y7KA0032	INTERLOCKED SOCKET 2P+T 16A IP65	€ 170,00
Y7KA0033	INTERLOCKED SOCKET 3P+ N+ T 16A IP65	€ 200,00
Y7KA0034	INFRARED MOTION DETECTOR IP44 FOR MORE MONOBLOCKS	€ 170,00
Y7KA0035	PANEL LED 40W UGR 19 FOR FALSE CEILING OFFICES	€ 240,00
Y7KA0037	TWILIGHT SWITCH IP44	€ 185,00
Y7KA0042	ELECTRICAL PROJECT, IF REQUIRED: FOR 220V-380V SYSTEMS FROM 6KW AND MORE	€ 1.820,00
Y7KA0045	THREE COMPARTMENTS ELECTRICAL CONDUIT	€/MT 25,00
Y7KA0046	EXTERNAL NEON LIGHTING 2X36 DARK LIGHT	€ 185,00
Y7KA0047	MOTION DETECTOR IP44	€ 160,00
Y7KA0048	ADDITIONAL FOR SWITCHBOARD WITH SAFETY DEVICE 4X16A id 0,03 IP44 + EXTERNAL WATERTIGHT BOX - 380V UNTIL 9KW	€ 775,00
Y7KA0049	ADDITIONAL FOR ELECTRICITY CONSUMPTIONS WITH IBOCO MODEL 05181	€ 45,00
Y7KA0050	ADDITIONAL FOR SWITCHBOARD WITH SAFETY DEVICE FOR THREE COMPARTMENTS ELECTRICAL CONDUIT 2X16A id 0,03 IP44 + EXTERNAL WATERTIGHT BOX	€ 240,00
Y7KA0053	ELECTRIC HAND DRYER SOCKET	€ 145,00
Y7KA0055	SPECIFIC LINE IN SWITCHBOARD FOR AIR EXTRACTOR FAN	€ 50,00
Y7KA0057	M10 VORTICE AIR EXTRACTOR FAN 100 m3/h	€ 270,00
Y7KA0058	M12 VORTICE AIR EXTRACTOR FAN 120 m3/h	€ 375,00
Y7KA0060	ADDITIONAL FOR TWO SWITCHES	€ 55,00
Y7KA0061	ADDITIONAL FOR THREE SWITCHES	€ 100,00

ECONOMICAL INSULATED SANITARY CABIN



External dimensions: cm 94 x 97 x 255H

Weight 100 kg

CODE	DIMENSIONS IN CM	PRICE
CACOBATLA	ASIAN STYLE WC + WASHBASIN 97X97X225H	€ 1.720,00
CACOBAWLA	WC TOILET + WASHBASIN 97X97X225H	€ 1.820,00

DEMOUNTABLE CONTAINER 4A
Width 220 cm



TECHNICAL DETAILS

STRUCTURE: galvanized sheets. Thickness 15/10 mm

WALLS AND CEILING: made of galvanized corrugated sheet. Thickness 6/10 mm

FLOOR: self-supporting finished with wood panels.

EQUIPMENT: double door, 04 hooks to elevate, capacity uniformly placed Kg1500.

CODE	DIMENSIONS IN CM	PRICE FOR DISASSEMBLED PRICE	PRICE FOR ASSEMBLED PRICE
CO4ABA30S (DISASSEMBLED) CO4ABA30M (ASSEMBLED)	300X220X220-450kg-	€ 2.100,00	€ 2.360,00
CO4ABA40S (DISASSEMBLED) CO4ABA40M (ASSEMBLED)	400X220X220-560kg-	€ 2.355,00	€ 2.615,00
CO4ABA50S (DISASSEMBLED) CO4ABA50M (ASSEMBLED)	500X220X220-650kg-	€ 3.010,00	€ 3.270,00
CO4ABA60S (DISASSEMBLED) CO4ABA60M (ASSEMBLED)	600X220X220-850kg-	€ 3.295,00	€ 3.555,00

Rev. 01/April 2023

STORAGE ISO CONTAINER



TECHNICAL DETAILS

STRUCTURE: section steel bars 3 mm.

WALLS AND CEILING: corrugated sheet 1,4 mm.

FLOOR: wood thickness mm 18.

FIXTURES: steel door with 2 shutters (opening 270°) it's packed all around. Lock with two security bars.

PAINTING: outer/inner **RAL 7035**.

EQUIPMENT: 2 holes for fork lift truck.

The steel floor is performed with the application of a sheet steel painted or embossed aluminium sheet, fixed to the floor by screws.

	CODE	DIMENSIONS IN MM	PRICE
--	------	------------------	-------

6'	COISBA06L (WOODEN FLOOR)	1980X1970X1910	€ 3.135,00
8'	COISBA08L (WOODEN FLOOR)	2438X2200X2260	€ 4.095,00
10'	COISBA10L (WOODEN FLOOR)	2991X2438X2591	€ 4.800,00

FIRST TRIP NAVAL CONTAINER



	CODICE	DIMENSIONI IN MM
20' BOX	CO1VBA20B	6050X2438X2591
20' HC	CO1VBA20H	6050X2438X2896
40' BOX	CO1VBA40B	12192X2438X2591
40' HC	CO1VBA40H	12192X2438X2896

For prices, contact the offices

SECOND HAND NAVAL CONTAINER



	CODICE	DIMENSIONI
20' BOX	COUSBA20B	6050X2438X2591
40' BOX	COUSBA40B	12192X2438X2591
CERTIFICAZIONE CSC EMESSA DA RINA		

For prices, contact the offices

052-521-324
www.bagi.hr
info@bagi.hr